

RP

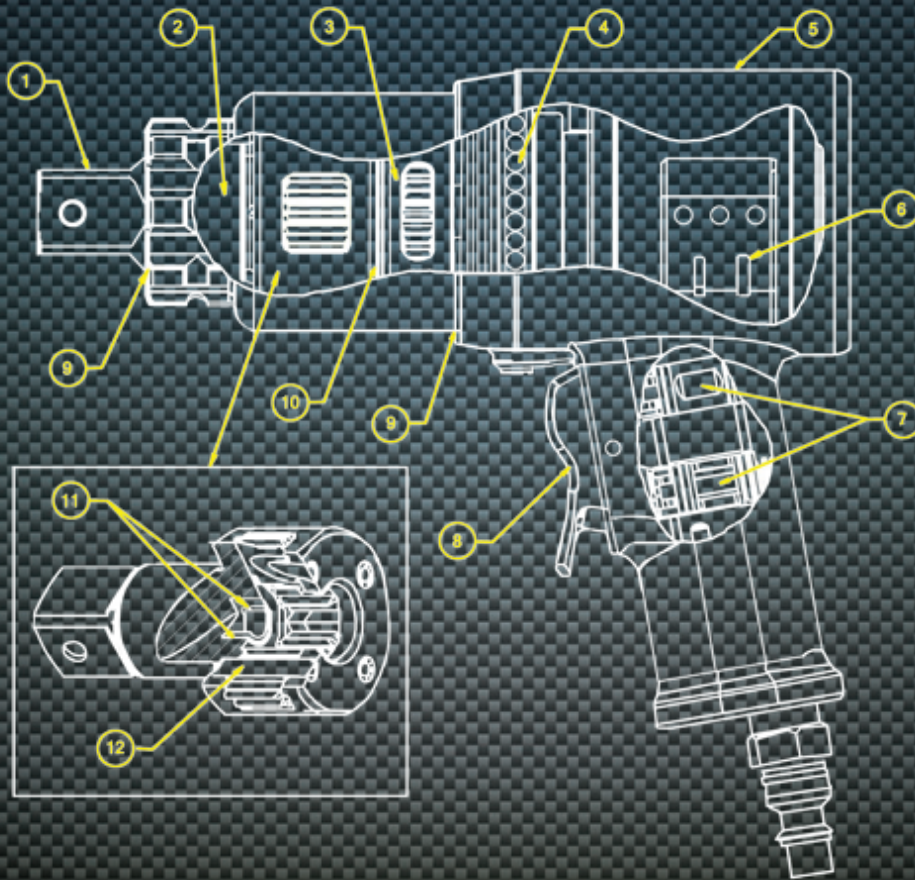



01. Hardened Alloy Steel
For durability and long cycle life

02. Bearings Support
For loads experienced at the square drive

03. Multiple Stage Planetary Gear System
With optimized tooth design

04. Smooth Ball Bearing Rotation
Gearbox housing independent from the motor handle

05. Lightweight Aluminum Handle
Provides durable, slip-resistant textured coating

06. Ultra-Efficient Air Motor
Designed for easy maintenance

07. Cartridge-Style Valves
Allow easy replacement

08. One Finger Trigger Control
For one touch forward and reverse

09. O-Rings
Seals grease in while keeping water and dirt out

10. Thrust Bearings
Isolates the motor when used in all orientations

11. Bearing Sleeves
Low friction, high strength that gears run on

12. Chrome Steel Pins
In each gear stage

RAPTOR RP Series Accessories

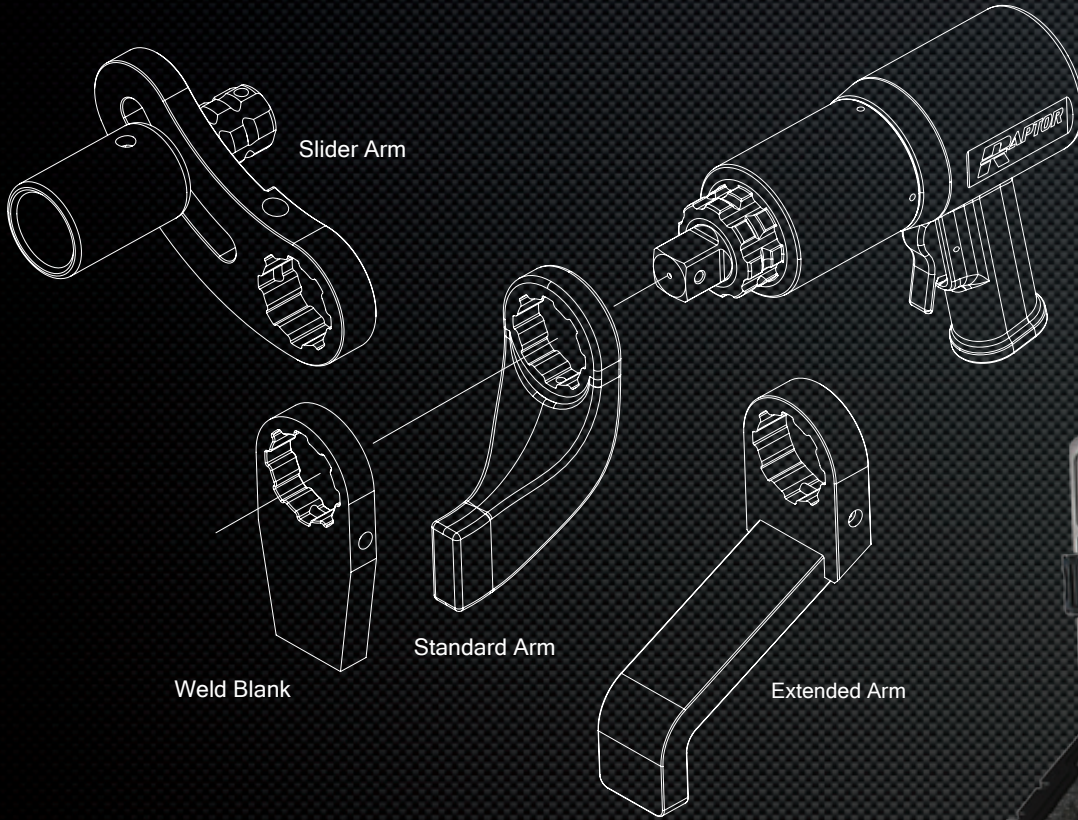

TECHNICAL DATA	RP-500	RP-1000	RP-2000	RP-3000	RP-6000
SQUARE DRIVE	3/4"	1"	1"	1"	1 1/2"
MIN TORQUE (ft/lbs)	130	300	460	1005	1525
MAX TORQUE (ft/lbs)	530	1030	2015	3070	5990
MIN TORQUE (nm)	176	407	624	1362	2067
MAX TORQUE (nm)	718	1396	2732	4162	8120
OUTPUT ACCURACY	+/-5%	+/-5%	+/-5%	+/-5%	+/-5%
REPEATABILITY	100%	100%	100%	100%	100%
DUTY CYCLE	100%	100%	100%	100%	100%
TOOL WEIGHT (lb)	9	12	16	20	36
TOOL WEIGHT (kg)	4.1	5.5	7.3	9.1	16.3
RPM @ 20 psi	26	11	6	3	2
TOOL MAX PSI	80 psi	70 psi	90 psi	65 psi	90 psi
RPM @ MAX psi	44	15	9	4	3

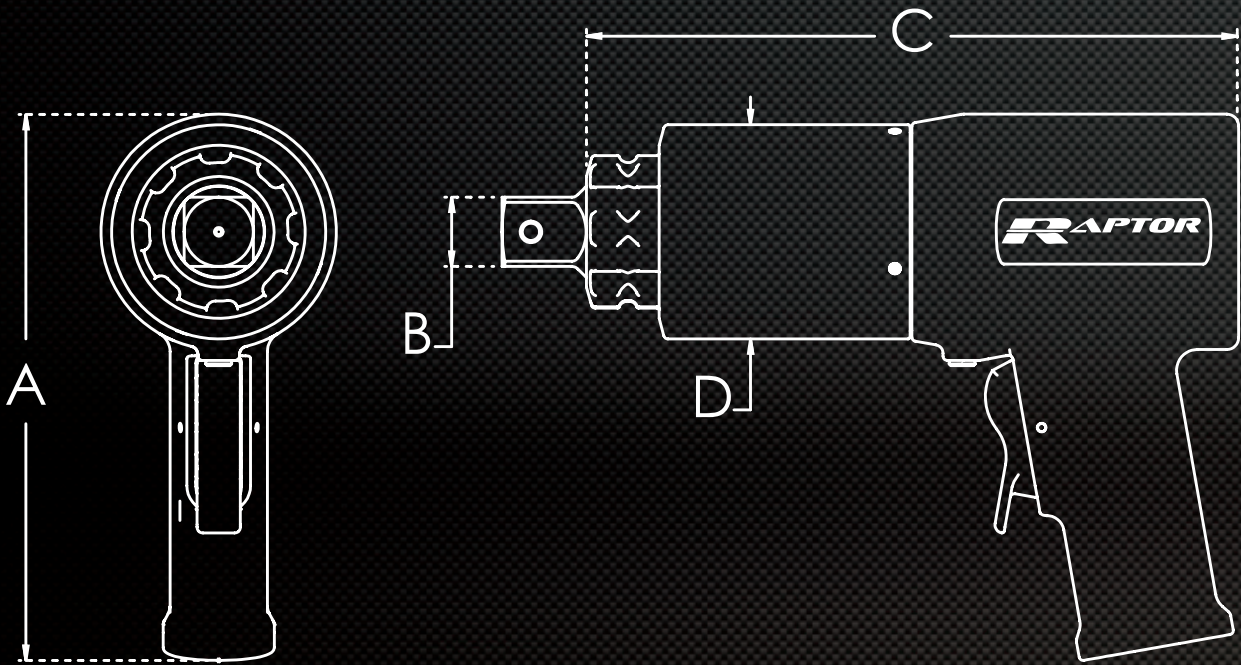

DIMENSIONAL DATA	RP-500	RP-1000	RP-2000	RP-3000	RP-6000
DIMENSION A (in)	7.89"	7.89"	7.89"	8.06"	8.69"
DIMENSION A (mm)	200.4	200.4	200.4	204.7	220.7
SQUARE DRIVE B (in)	0.75"	1"	1"	1"	1.5"
SQUARE DRIVE B (mm)	19.05	25.4	25.4	25.4	38.1
DIMENSION C (in)	6.80"	8.68"	9.40"	10.62"	12.32"
DIMENSION C (mm)	172.7	220.5	238.8	269.7	312.9
DIAMETER D (in)	2.56"	2.85"	3.09"	3.75"	5.00"
DIAMETER D (mm)	65.0	72.4	78.5	95.3	127.0